



Installation instructions

OPTION - Pull strap



Link to
Technical sheet
OPTION - Pull strap

scan me



Retrouvez toutes nos solutions
RIDEAU ALUMINIUM
DES VEHICULES SPECIAUX
sur www.mcd-fr.com

Accessories for OPTION Pull strap:

1 -> Rivet 4.8 x 16

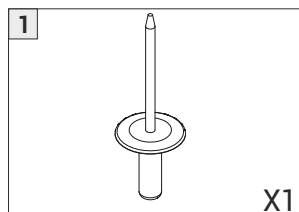

Installation STANDARD Pull strap

- 1 Place the strap in front of the specific side panel hole as display on the drawing below (prepare a rear space if necessary). Put the rivet to hold the position of the strap on the side panel.

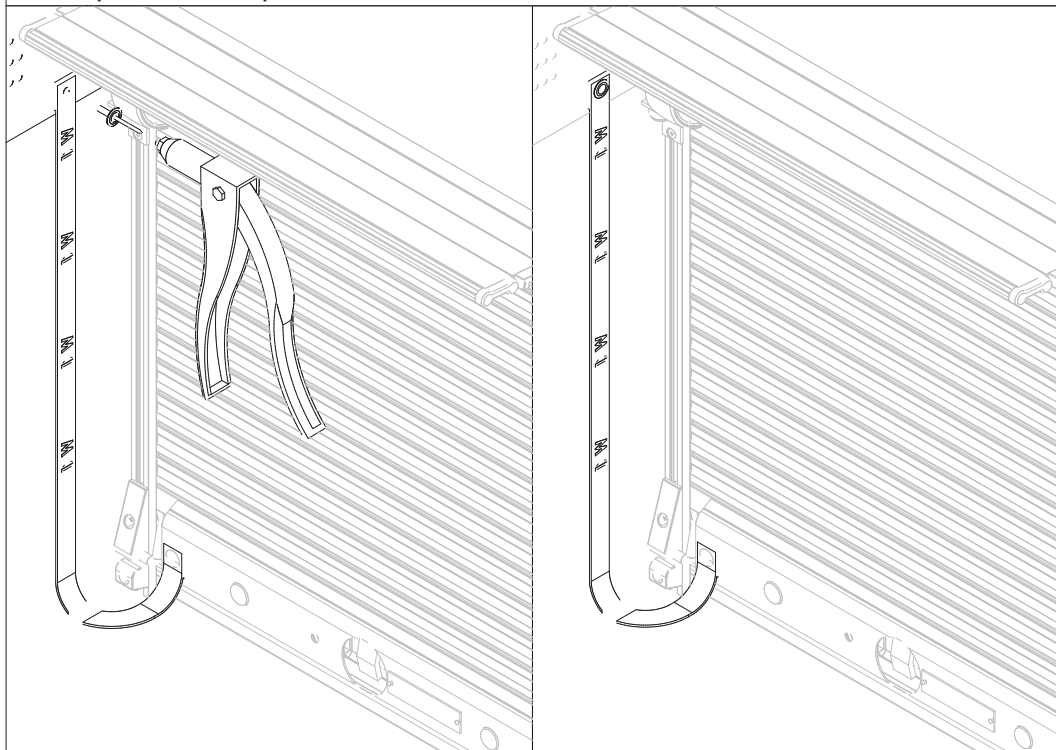

Installation RUBBER Pull strap

- 1 Prepare a hole to install the rubber strap on the side wall at half way of the track. Drill and put the rivet to hold the strap position.

