



# Installation instructions

## Alu30 IZY- Alu40 IZY

Alu30 IZY



scan me

Alu40 IZY



scan me

Link to  
technical sheet  
Alu30 - Alu40 IZY



Retrouvez toutes nos solutions  
RIDEAU ALUMINIUM  
DES VEHICULES SPECIAUX  
sur [www.mcd-fr.com](http://www.mcd-fr.com)

## Common contents of the parcel

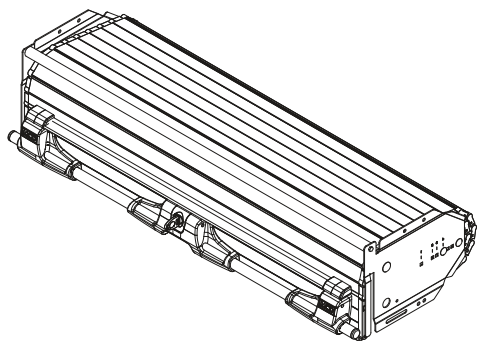

A preassembled shutter

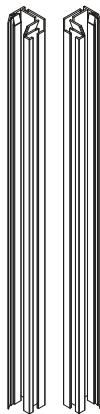

A pair of tracks

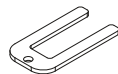

Accessories

**Common accessories contents:** Blocking fork

**Optionnal accessories contents:**

### Double handle closing system

- 1 -> Double handle
- 2 -> Caps
- 3 -> Screw TH 4X10
- 4 -> Ring Az4

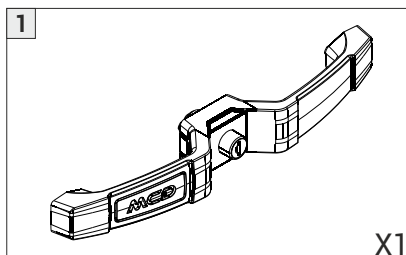

X1

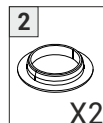

X2



X4



X4

### Bar lift handle closing system

- 1 -> Blocking strikers
- 2 -> Top stoppers
- 3 -> Black rivet 3.2

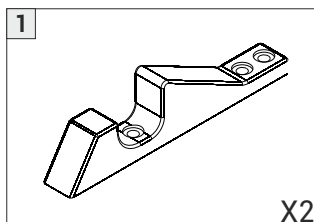

X2

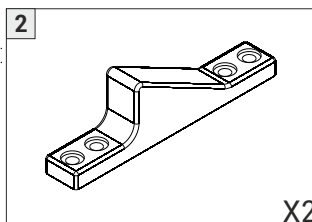

X2

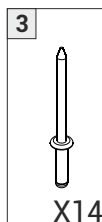

X14

### Pull strap option

- 1 -> Rivet 4.8 x 16

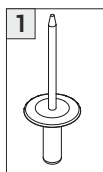

## Interior unlocking option for double handle

- 1 -> Assembled omega
- 2 -> Opening pedal
- 3 -> Deck plate
- 4 -> Vis poelier 6X30
- 5 -> Rivet 4X8

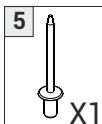
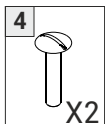
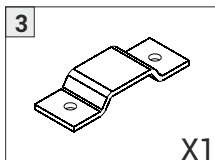
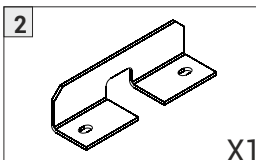
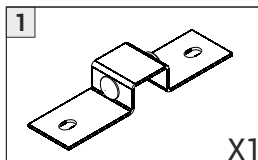

## Interior unlocking option for bar lift handle

- 1 -> Assembled option
- 2 -> Rivets 4.8X10
- 3 -> Rivets 4X8
- 4 -> Deck plate

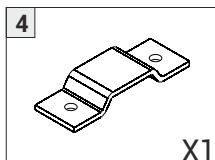
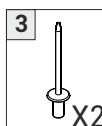
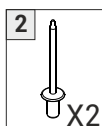
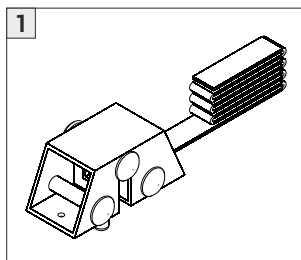

## Electric locking system option

- 1 -> Electro magnet
- 2 -> Rivet 4.8X10

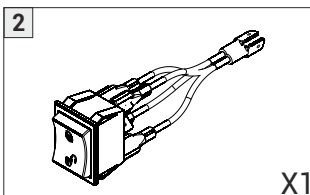
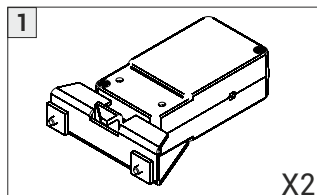

## Options

### LED lightings

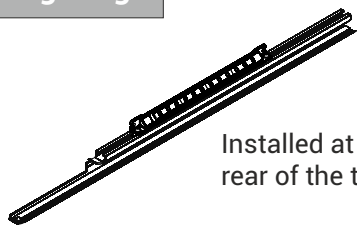

Installed at the rear of the tracks

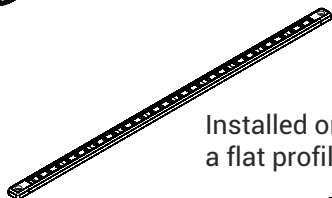

Installed on a flat profile



Installed on the drip channel

### Sensors

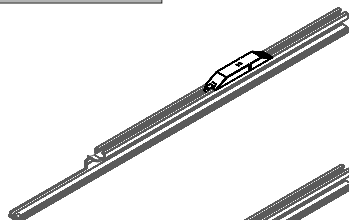

Magnetic sensor

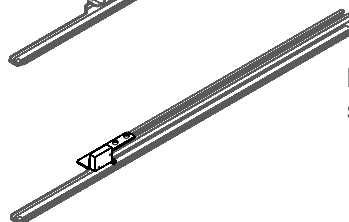

Mechanical sensor

### Additional profiles

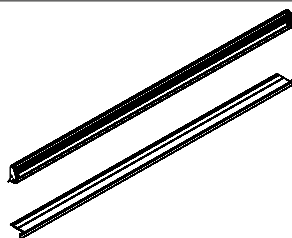

Sill plate and drip channel

# Installation

## 1 Sill plate installation (option)

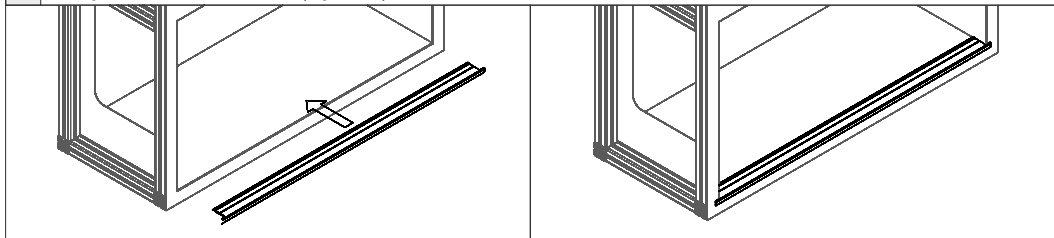

## 2 Mount the side tracks and preassembled shutter together in front of the locker (the tracks have a special dedicated hole on which you glide the side panels into (1-2))

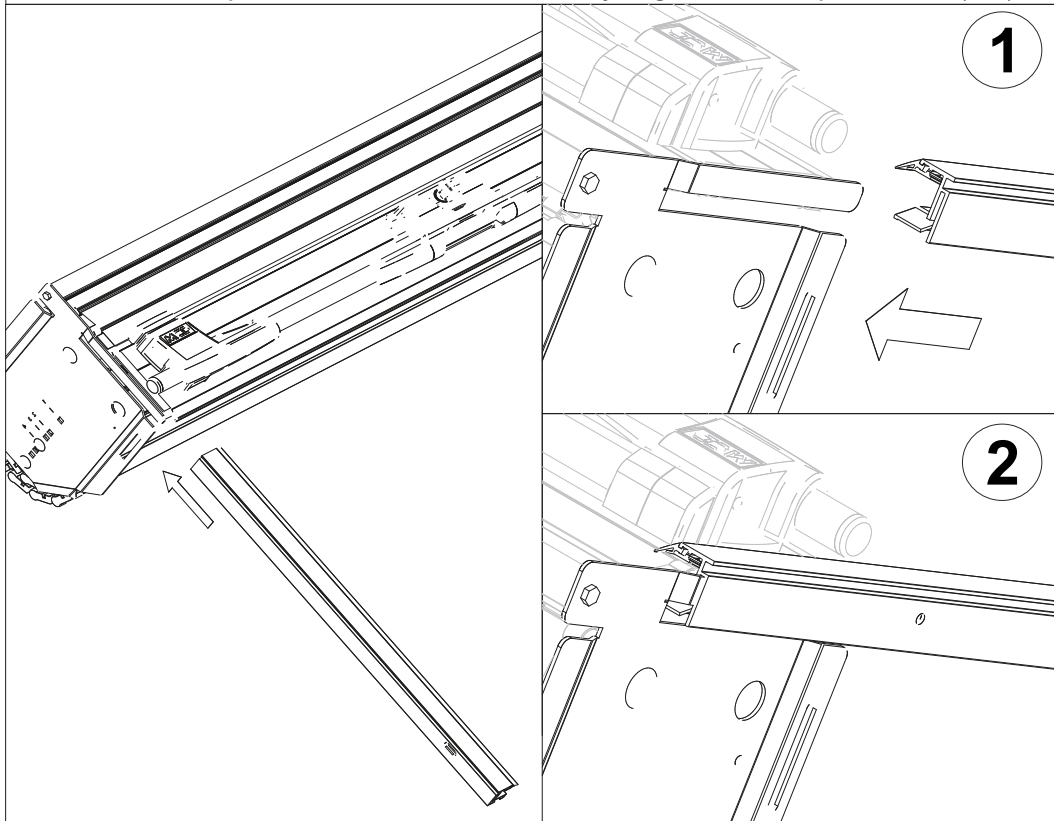

## Installation

- 3** Take the whole shutter assembly (2 persons) and place it inside the compartment. Attach the tracks of the bodywork with screws.

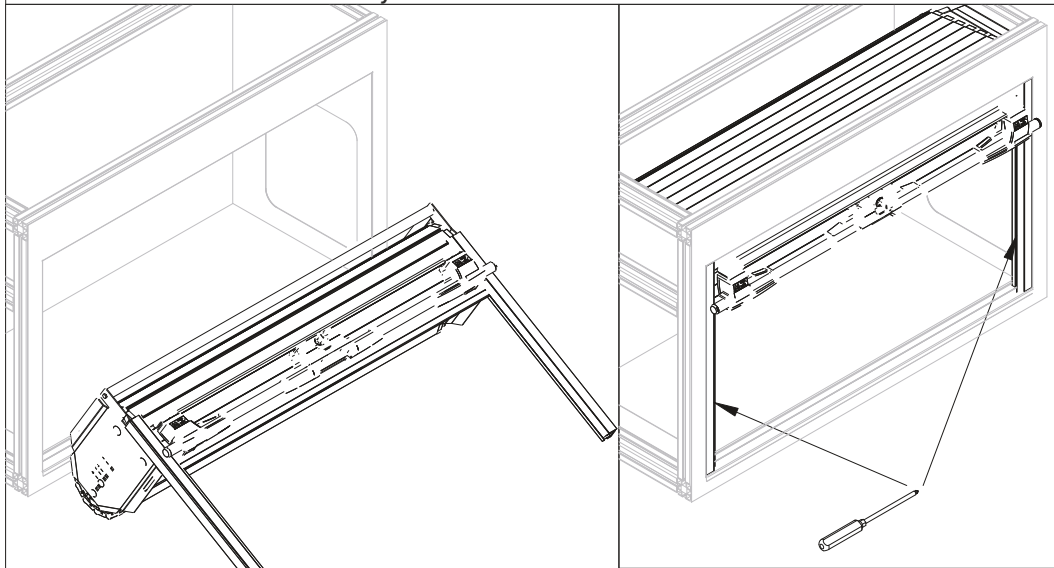

- 4** Attach the side panels on the bodywork. Several drillings are available following the available space in the locker (1-2).

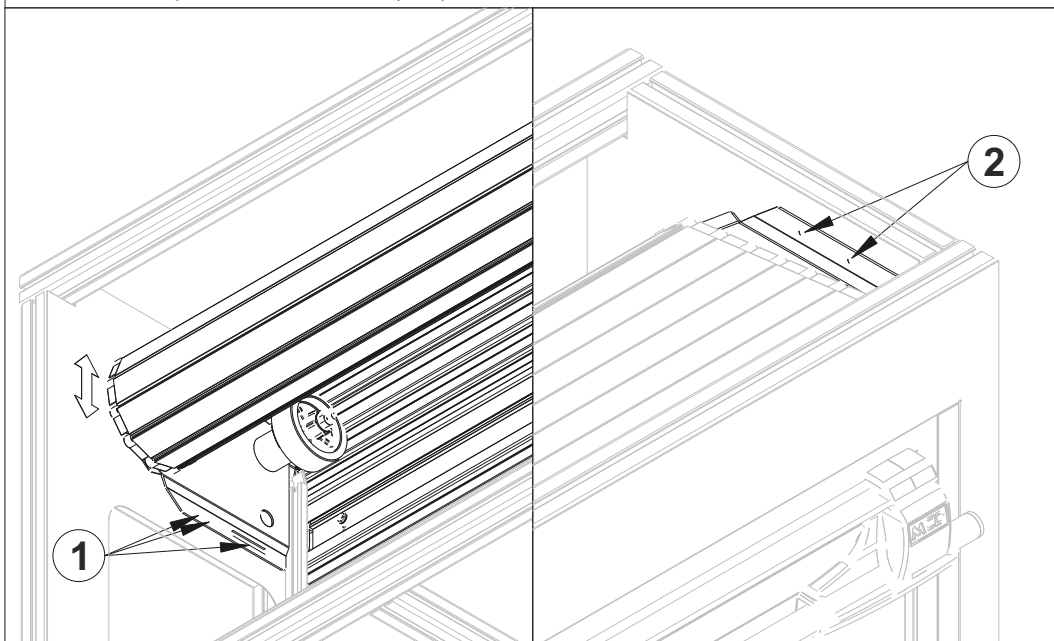

# Installation

- 5** Prepare together the drip channel profile (option) and the top seal. Remove 1 cap and the drip channel seal (1) in order to glide or glue (depending of your chosen top seal model). Cut the additional unnecessary top seal part (2).

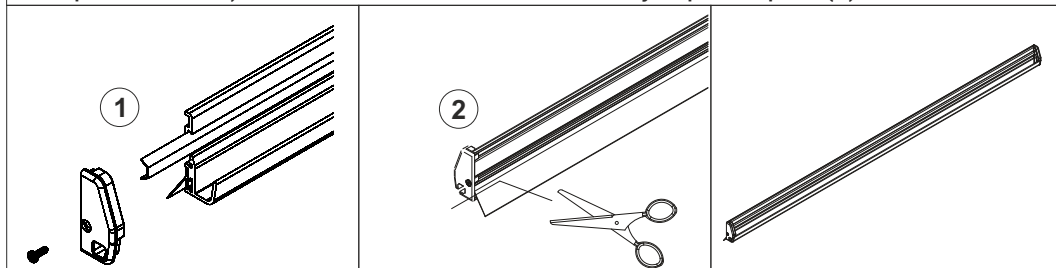

- 6** Place the drip channel on the bodywork against the header and attach it with screws or rivet behind the seal. Once installed, put back the drip channel seal and cap.

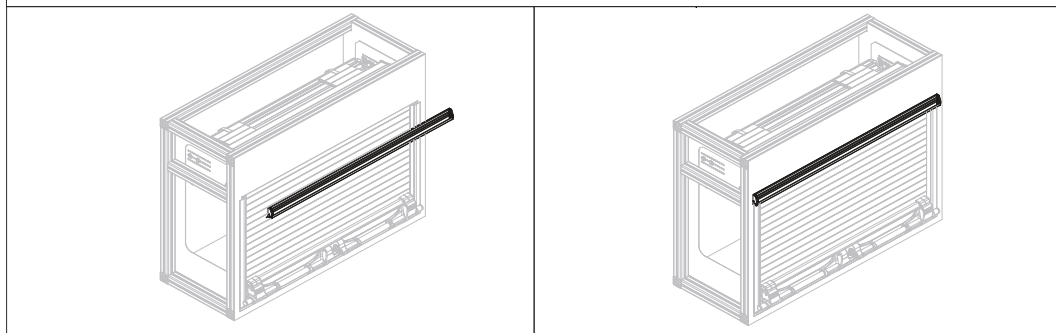

- 7** Put the blocking strikers and top stoppers in position taking care to place the bar tube inside the dedicated area and compress the bottom seal for 1/3. Drill and put the rivet to hold the position.

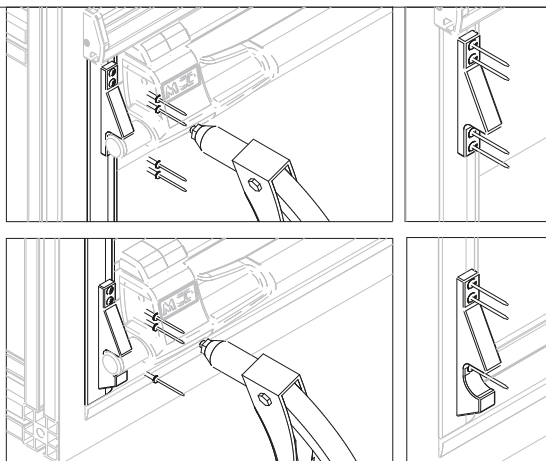

## Installation

- 7\*** Install the double handle on the bottom shutter profile thanks to the screws supplied in the packet of accessories.

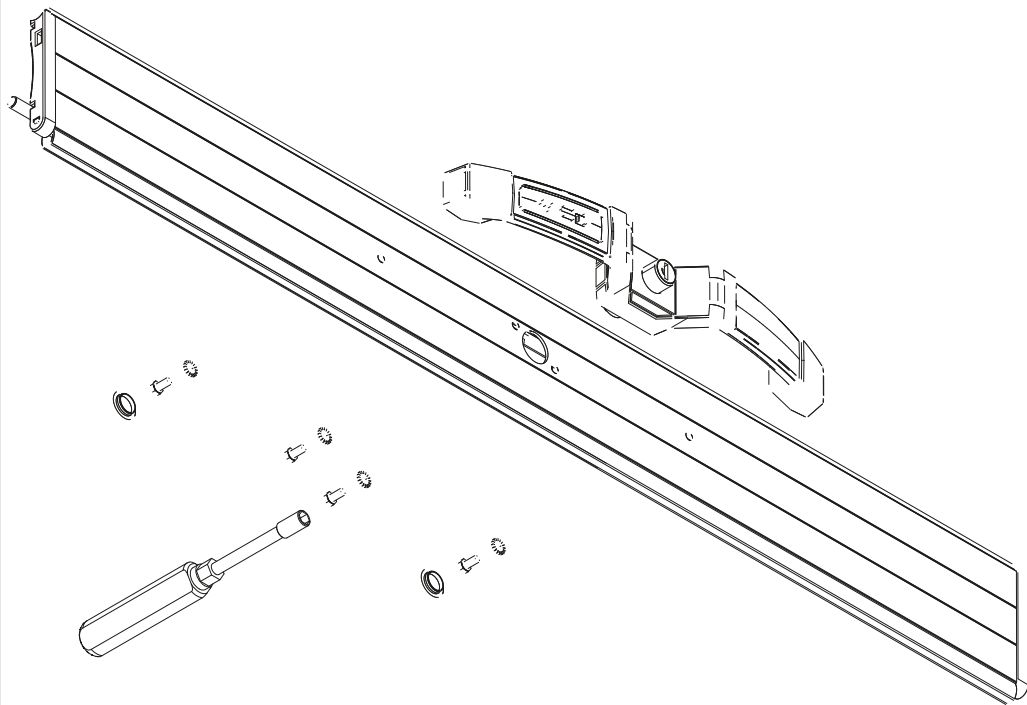

Place the locking rod into the bottom blocking strikers. Close the shutter taking care to compress the bottom seal for 1/3. Hold the position on the tracks thanks the screws.

