

THE OPTIONS

# Compartment LED lighting

# the options

## Compartment LED lighting

MCD LED lighting system is composed of a flexible LED ribbon where are integrated some CMS LED fully covered by a resin to make waterproof the whole system (IP67). As difference from basic ribbon available on the market, our LED has been develop to fit vehicles requirements with some additionnals electronic components to protect the system for automotive use.

Those LED are available in 2 voltages to precise at ordering time: 12 or 24V. MCD can adjust the lenght by step of 100mm.

We can integrate those LED in 2 kinds of aluminium profiles following your requirements:

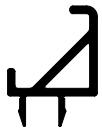

1. An aluminium profile with 2 end caps, clipped onto the rear of the tracks, with 45° orientation to the inside of the locker.



2. A flat aluminium profile with 2 end caps ready to install everywhere on a flat surface.



## Advantages

- Uniform light distribution all along the locker height
- Fully integrated to the shutter components
- Instant lighting
- Automotive electronic protections
- Adjustable lighting position
- High-performance white lighting
- Reduced consumption : 14,4W/m
- Waterproof system IP67



The options  
**Compartment  
 LED lighting**  
*Exploded view*

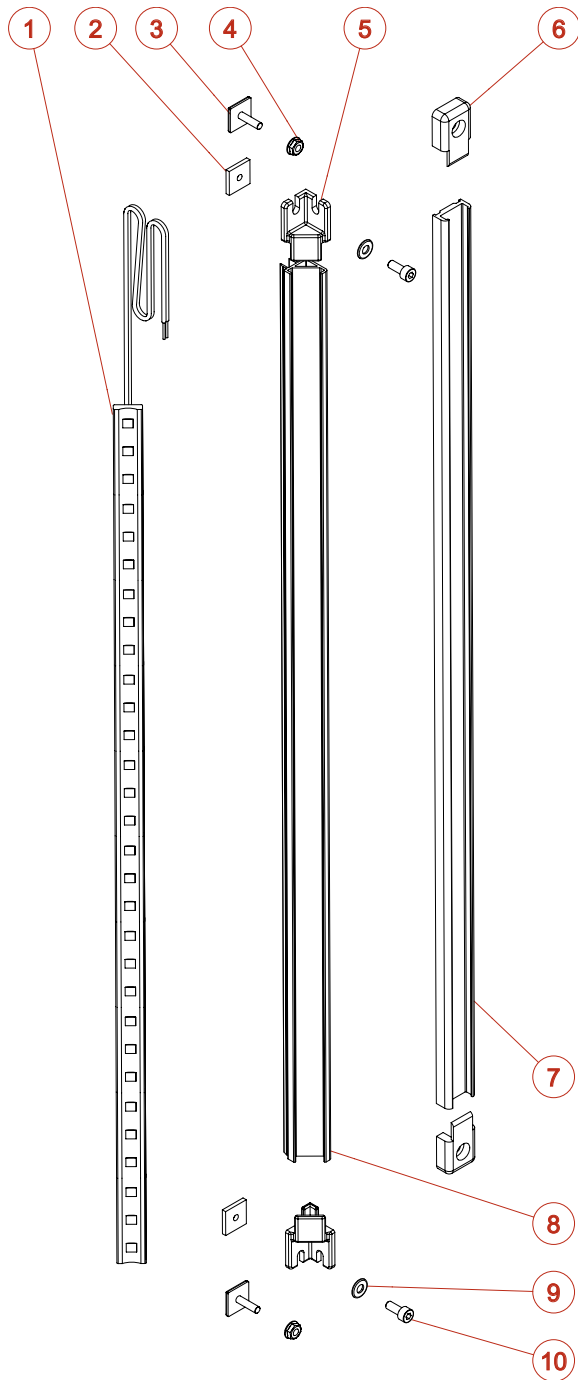

The options **Compartment LED lighting**  
*Elements list*

N°	Ref	Description
1	7085	30CM LED RIBBON 12V
1	7040	50CM LED RIBBON 12V
1	7081	70CM LED RIBBON 12V
1	7041	100CM LED RIBBON 12V
1	7042	150CM LED RIBBON 12V
1	7043	200CM LED RIBBON 12V
1	7060	250CM LED RIBBON 12V
1	7061	300CM LED RIBBON 12V
1	7062	350CM LED RIBBON 12V
1	7063	400CM LED RIBBON 12V
1	7085	30CM LED RIBBON 24V
1	7045	50CM LED RIBBON 24V
1	7086	70CM LED RIBBON 24V
1	7046	100CM LED RIBBON 24V
1	7047	150CM LED RIBBON 24V
1	7048	200CM LED RIBBON 24V
1	7065	250CM LED RIBBON 24V
1	7066	300CM LED RIBBON 24V
1	7067	350CM LED RIBBON 24V
1	7068	400CM LED RIBBON 24V
2	3200	STAINLESS SQUARE NUT M4
3	3201	SPECIAL SQUARE SCREW 4X13 FOR LED
4	3527	NUT M4
5	4267	END CAP FOR LED 45° PROFILE
6	4268	END CAP FOR LED UNIVERSAL FLAT PROFILE
7	1802	UNIVERSAL ALUMINIUM FLAT PROFILE FOR LED
8	1801	45° ALUMINIUM PROFILE FOR LED
9	3370	STAINLESS RING M4
10	3308	STAINLESS SCREW CHC 4X10