

# Alucoffre

A close-up photograph of the identification plate on the aluminum blind. The plate is silver with a red MCD logo on the left. Text on the plate includes "Le rideau aluminium des véhicules spéciaux" and "N° de Série / Serial#". Below this, it says "made in France". A date stamp "1999" is visible on the right side of the plate.

**MCD**  
The **Aluminium**  
**Roller shutter**  
for specials vehicles

# Alucoffre

The Alucoffre shutter is made to measure with double-walled extruded slats of 30mm height. The door can be used to close compartment or as loading access door in all kind of vehicles as replacement of conventionnal swing doors to optimise the space inside and outside.

As difference from our others shutters models, the Alucoffre is not balanced thanks to a spring system to assist user when opening the door. The shutter is sent in horizontal tracks at opening + rear of the compartment (if the depth is smaller than the shutter opening height).

This reduces considerably the minimum header dimension required to 75mm only in order to hide the mechanism.

This shutter model is adapted to small shutters surface by its low obstruction level (no balancer) and its passing height increased thanks to specific handles, smaller, adapted to that use (profile handle).

However, the weight of the shutter to lift could be quickly too heavy and dangerous for user if the dimensions are not controlled.

Then, we limit the shutter surface area to a maximum of 0.5m<sup>2</sup>.



The product is delivered in different parts ready to install:

- 1 assembled shutter
- 1 pair of vertical side tracks drilled
- 1 pair of horizontal side tracks drilled
- 1 packet of accessories

## Maximum / Minimum product dimensions

Maximum Height	1000 mm
Maximum Width	1000 mm
Minimum Width	100 mm
Maximum surface area	0,5 m <sup>2</sup>
Weight of the shutter /m <sup>2</sup>	12 Kg

The SHUTTER  
system  
**Alucoffre**  
Personnalization

The **Alucoffre** shutter model is fully customizable:  
colour finish of the components, tracks models, closing system and options:  
(bended tracks, pull strap, interior unlocking, sensors, LED lighting integrated, electric locking system).

*You can personalized your shutter according to the below specifications:*

## 1. COLOUR FINISH OF THE COMPONENTS

The standard colour finish is a powder coated epoxy paint grey RAL 7035 or white RAL 9010.  
We also propose several usual RAL colour kept in stock or any others RAL colour on demand following shutter quantities.  
Our shutters are also available in anodized finish.



Example of  
COLOUR FINISH



DOUBLE HANDLE  
personalized

BAR LIFT HANDLE  
with personalized logo

## 2. THE CLOSING SYSTEM

The closing of the shutter  
is done by different possibilities of handle  
with or without key.

It's possible to supply the same key number  
for different shutters on a same order  
if many doors equip the same vehicle.

Built-in  
HANDLE

Double  
HANDLE

Bar lift  
HANDLE

Profile  
HANDLE





### 3. SIDE TRACKS MODELS

We propose 2 kind of side tracks following bodywork possibilities:

#### Standard side tracks

The standard side tracks can be installed in any bodywork configuration. It's a simple «U» shape in which the shutter glide.

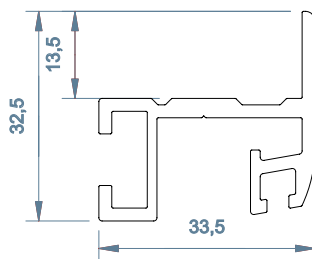
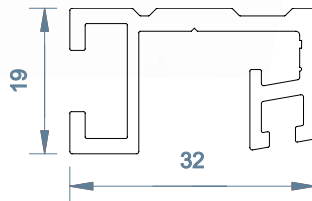

#### Overlapping side tracks

The overlapping side track required a specific construction.

As the tracks overlap the vehicle bodywork, then it's necessary to have a header thickness < 9mm to let free the shutter way to go out of its tracks (see details below).

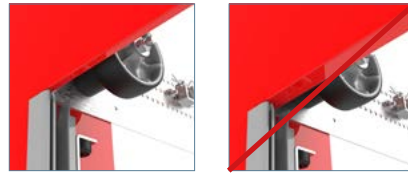

### 4. OPTIONNAL EQUIPMENTS

Many additionnal options are available on demand to answer each requirement:

- Bended tracks following your drawing
- Pull strap to catch the shutter handle when installed too high
- Sill plate and drip channel profiles for a better handling of water rejects
- Sensors for automatic compartment lighting when opening the shutters
- LED compartment lighting integrated in the side tracks or in a special drip channel profile
- Electric locking system
- Interior unlocking



LED LIGHT  
integrated in the  
side tracks

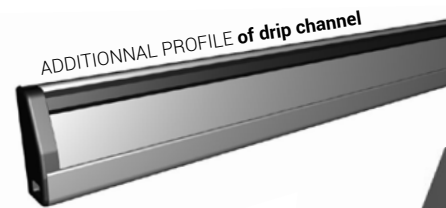

ADDITIONNAL PROFILE of drip channel

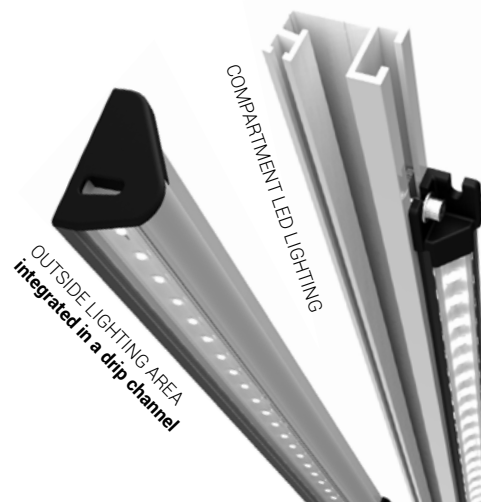

OUTSIDE LIGHTING AREA  
integrated in a drip channel

COMPARTMENT LED LIGHTING

BENDING of the tracks following your drawing

The SHUTTER  
system  
**Alucoffre**  
*Setting up*

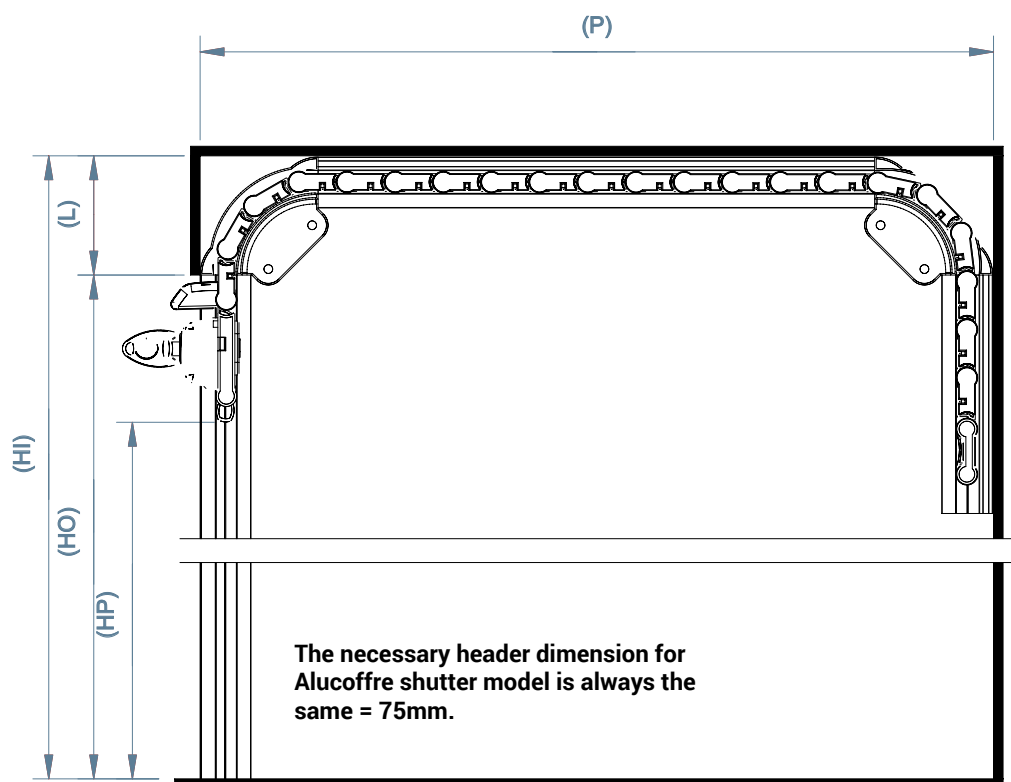

	Description
HI	Interior Height
HO	Opening Height
HP	Passing Height
L	Header
P	Depth
LP	Passing Width
LER	Total Width

**To remember :**

$$HI = HO + L$$

$$HP = HO - 100 \text{ mm}$$

$$L.P = LER - 60 \text{ mm}$$

$$L = 75 \text{ mm}$$

As difference from classical swing door, a **shutter required a top header panel** in order to hide the shutter mechanism.

The articulation of the shutter's slats in the top part **shouldn't be visible from the outside of the vehicle**.

The shutter should remain straight all along the opening.





The SHUTTER  
system  
**AluCoffre**  
*Exploded view*

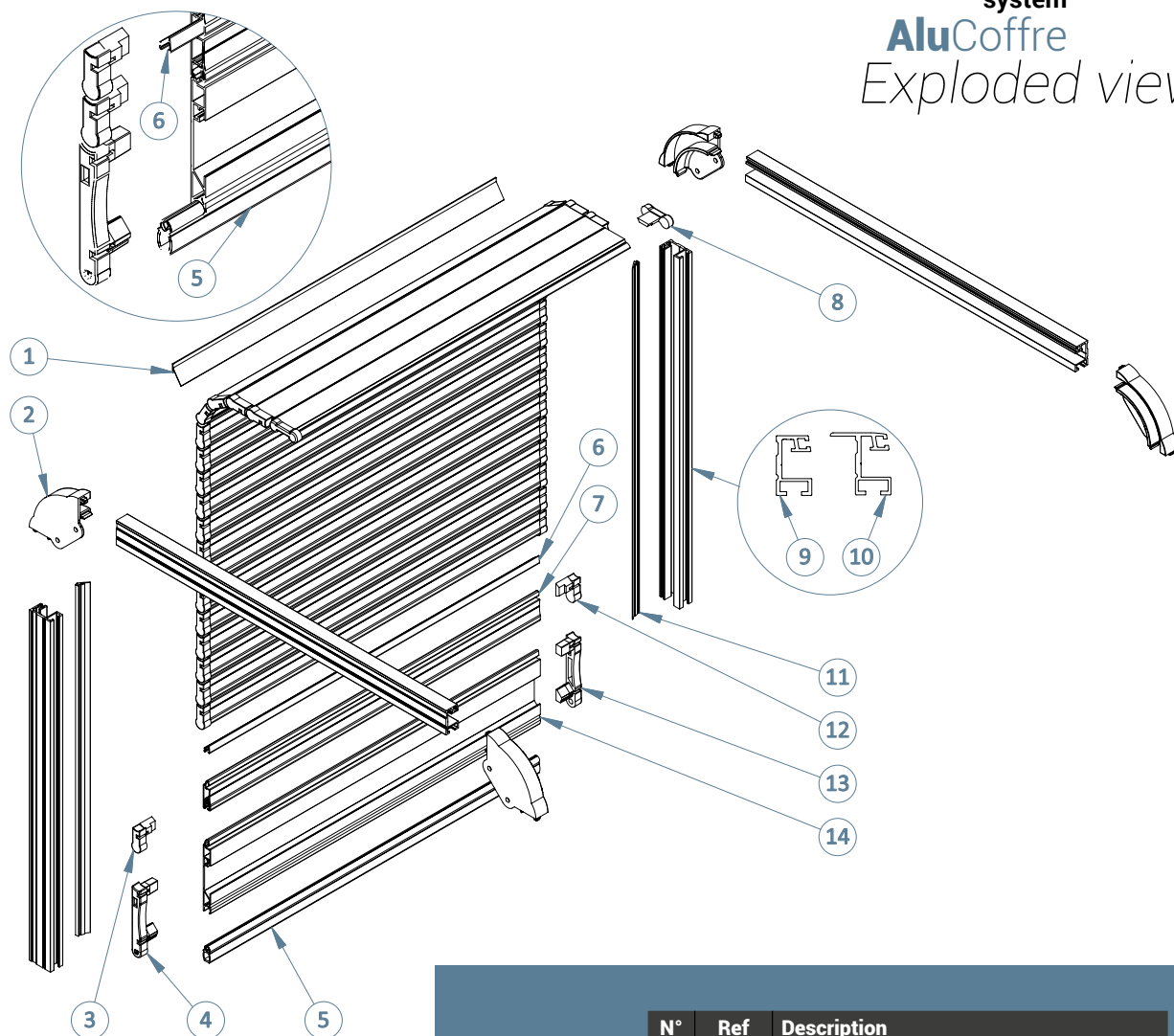

**AluCoffre**  
elements list

N°	Ref	Description
1	2030	TOP SEAL (ML)
2	4300	PVC 90° CORNER
3	4002	LEFT END CAP FOR 30MM SLAT
4	4017	LEFT END CAP FOR BOTTOM PROFILE
5	2010	BOTTOM SEAL (ML)
6	2005	INNER SLAT SEAL (ML)
7	1009	ALUMINIUM SLAT 30MM V2 (ML)
8	4004	TOP SLAT END CAP
9	1300	STANDARD SIDE TRACKS (ML)
10	1305	OVERLAPPING SIDE TRACKS (ML)
11	2024	SIDE TRACKS SEAL (ML)
12	4003	RIGHT END CAP FOR 30MM SLAT
13	4018	RIGHT END CAP FOR BOTTOM PROFILE
14	1101	BOTTOM ALUMINIUM PROFILE (ML)