

SHUTTER

Alu30

front roll



Alu30

front roll

The Alu30 front roll shutter is made to measure with double-walled extruded slats of 30mm height.

The door can be used to close compartments or as loading access door in all kind of vehicles as replacement of conventional swing doors to optimise the space inside and outside.

It's delivered in different parts ready to install:

- 1 assembled shutter
- 1 pair of side tracks already drilled
- 1 balancer
- 1 packet of accessories



Maximum / Minimum product dimensions

Maximum Height	2200 mm
Maximum Width	2500 mm
Minimum Width	355 mm
Maximum surface area	4 m ²
Weight of the shutter /m ²	12 Kg

The SHUTTER
system
Alu30 front roll
Personnalization

The **ALU30 front roll** shutter model is fully customizable:
colour finish of the components, tracks models, closing system and options:
(bended tracks, pull strap, interior unlocking, sensors, LED lighting integrated, electric locking system).

You can personnalized your shutter according to the below specifications:

1. COLOUR FINISH OF THE COMPONENTS

The standard colour finish is a powder coated epoxy paint grey RAL 7035 or white RAL 9010.
We also propose several usual RAL colour kept in stock or any others RAL colour on demand following shutter quantities.
Our shutters are also available in anodized finish.



Examples of
COLOUR FINISH

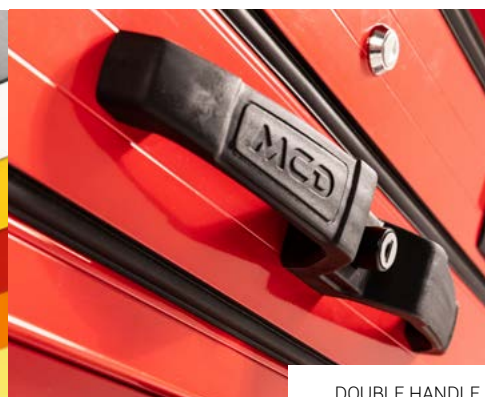

DOUBLE HANDLE
personnalized

BAR LIFT HANDLE
with personnalized logo

2. THE CLOSING SYSTEM

The closing of the shutter
is done by different possibilities of handle
with or without key.

It's possible to supply the same key number
for different shutters on a same order
if many doors equip the same vehicle.

Built-in
HANDLE

Double
HANDLE

Bar lift
HANDLE





3. SIDE TRACKS MODELS

We propose 2 kind of side tracks following bodywork possibilities:

Standard side tracks

The standard side tracks can be installed in any bodywork configuration. It's a simple «U» shape in which the shutter glide.

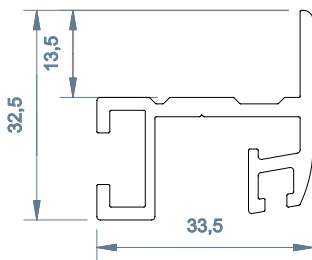
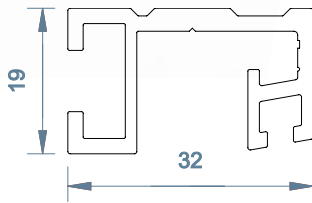

Overlapping side tracks

The overlapping side track required a specific construction.

As the tracks overlap the vehicle bodywork, then it's necessary to have a header thickness < 9mm to let free the shutter way to go out of its tracks (see details below).

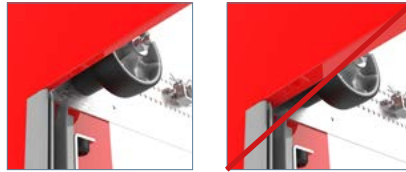

ADDITIONNAL PROFILE of drip channel

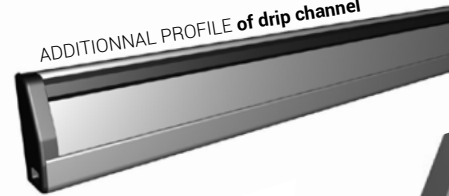

4. OPTIONNAL EQUIPMENTS

Many additionnal options are available on demand to answer each requirement:

- Bended tracks following your drawing
- Pull strap to catch the shutter handle when installed too high
- Sill plate and drip channel profiles for a better handling of water rejects
- Sensors for automatic compartment lighting when opening the shutters
- LED compartment lighting integrated in the side tracks or in a special drip channel profile
- Electric locking system
- Interior unlocking

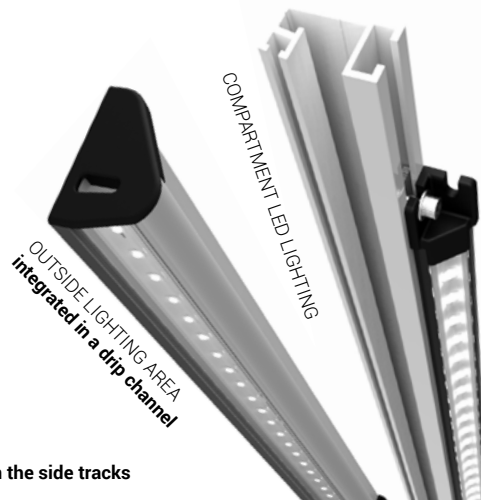

LED LIGHT
integrated in the side tracks

BENDING of the tracks following your drawing

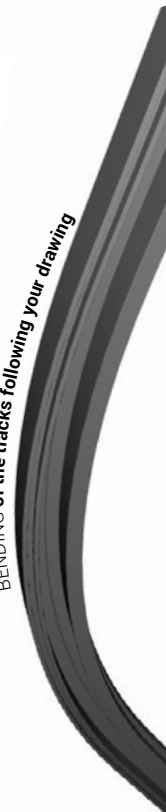

The SHUTTER system

Alu30 front roll

Setting up

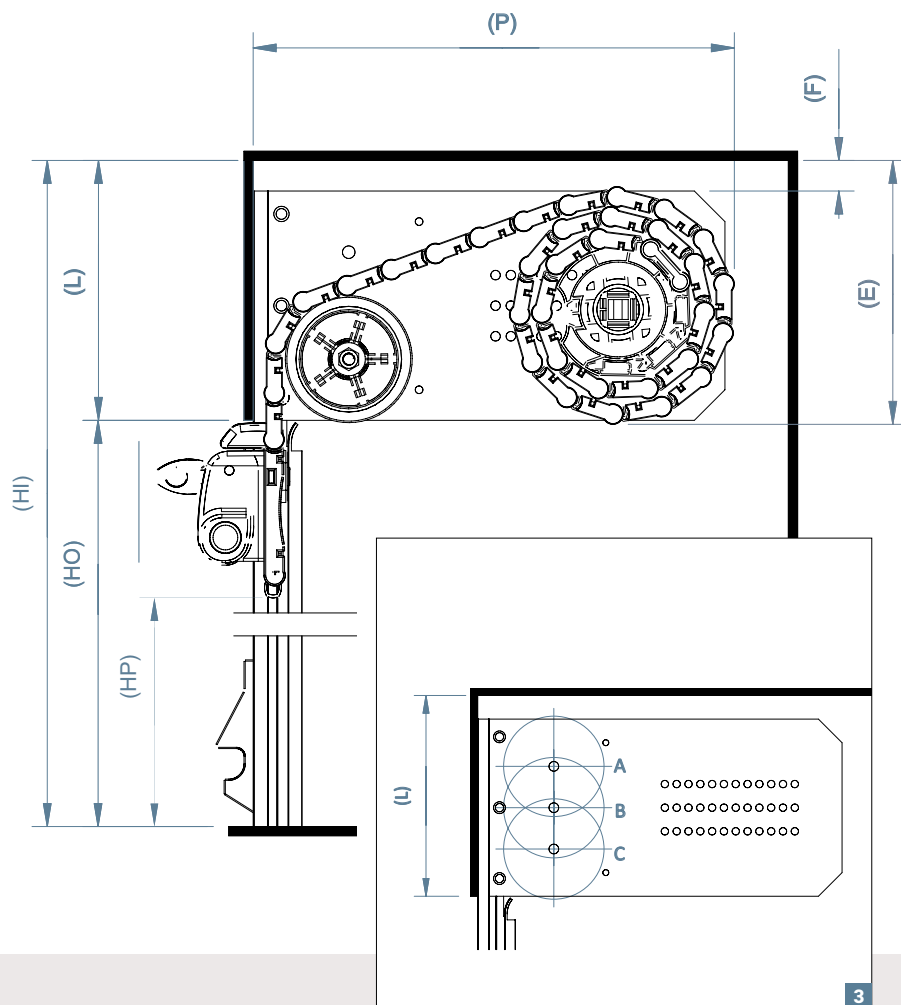

	Description
HI	Interior Height
HO	Opening Height
HP	Passing Height
L	Header
P	Depth
LP	Passing Width
LER	Total Width

To remember :

$$HI = HO + L$$

$$HP = HO - 100 \text{ mm}$$

$$LP = LER - 60 \text{ mm}$$

As difference from classical swing door, **a shutter required a top header panel** in order to hide rolling mechanism (*picture 1*).

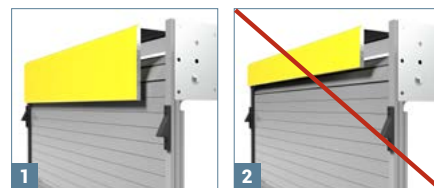

The articulation of the shutter's slats in the top part **shouldn't be visible from the outside of the vehicle**.

The shutter should remain straight all along the opening (*picture 2*).

The necessary header dimension to prepare and space required in the compartment to roll the shutter is defined following shutter Opening Height and guiding wheel position (Picture 3).

The board beside will help you to determinate the necessary space to install your roller shutter.

Internal dimensions (in mm)

Turns of tension	Opening Height (H.O)	L minimum			P	E	F
		A	B	C			
2	0 à 700	80	110	140	240	160	20
3	700 à 1150	80	110	140	260	180	20
4	1150 à 1700	100	120	140	290	200	30
5	1700 à 2300	120	140	160	310	220	40

The SHUTTER
system
Alu30 front roll
Setting up

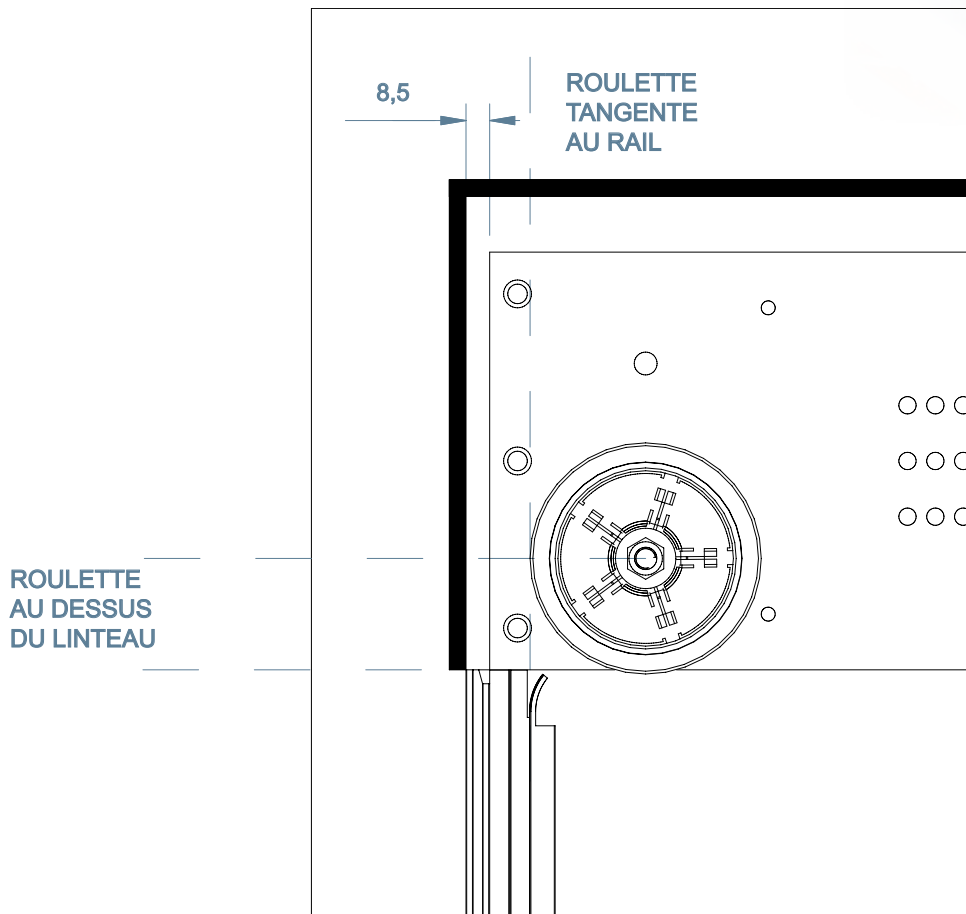
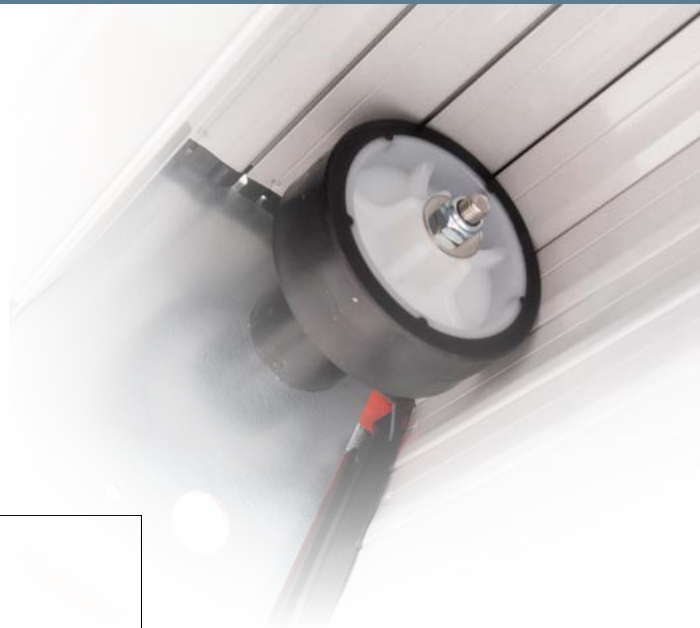

The guiding wheel position must be always above the bottom part of the header, and must be tangent to the entrance of the tracks to avoid hanging it.

The SHUTTER
system
Alu30 front roll
Exploded view

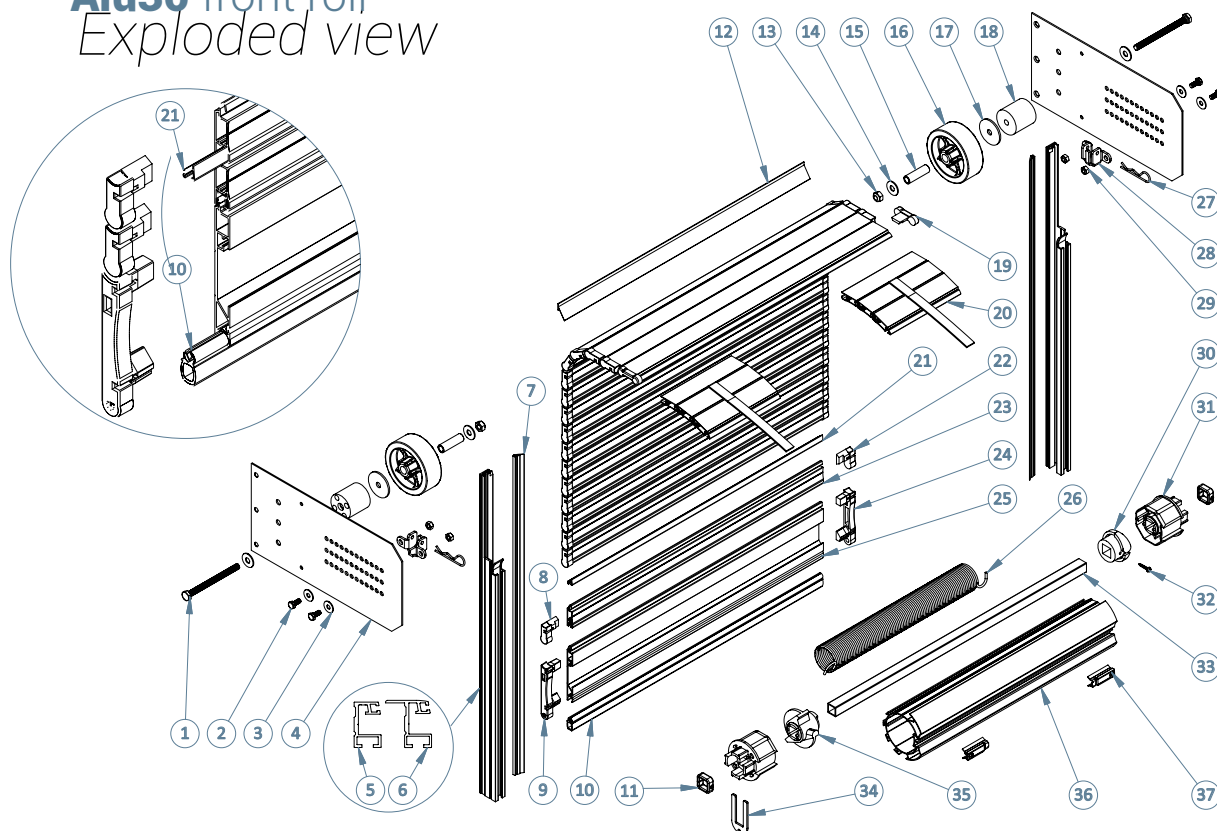

Alu30 front roll
elements list

N°	Ref	Description
1	3300	STAINLESS SCREW TH 8X100
2	3507	ZINC COATED SCREW TH 6X14
3	3304	STAINLESS RING L6
4	3115	ALU30 SIDE PANEL
5	1300	STANDARD SIDE TRACKS (ML)
6	1305	OVERLAPPING SIDE TRACKS (ML)
7	2024	SIDE TRACKS SEAL ML)
8	4002	LEFT END CAP FOR 30MM SLATS
9	4017	LEFT END CAP FOR BOTTOM PROFILE
10	2010	BOTTOM SEAL (ML)
11	3104	STEEL STIRUP WITH SCREW
12	2030	TOP SEAL (ML)
13	3506	ZINC COATED LOCK NUT M8
14	3301	STAINLESS RING L8
15	3109	STEEL SPACER
16	4110	GUIDING WHEEL DIAMETER 80MM
17	3523	ZINC COATED RING M8X40X2.5
18	4107	PVC SPACER
19	4004	TOP SLAT END CAP

N°	Ref	Description
20	8113 30	FASTENNER KIT SLATS 30MM
21	2005	INNER SLAT SEAL (ML)
22	4003	RIGHT END CAP FOR 30MM SLATS
23	1009	ALUMINIUM SLAT 30MM V2 (ML)
24	4018	RIGHT END CAP FOR BOTTOM PROFILE
25	1101	BOTTOM ALUMINIUM PROFILE (ML)
26		SPRING
27	3371	GSTAINLESS BETA PIN 2.5
28	3139	BALANCER BRACKET
29	3503	ZINC COATED LOCK NUT M6
30	4104	FIX SPRING BRACKET FOR BALANCER 62MM
31	4100	END CAP FOR BALANCER 62MM
32	3309	STAINLESS SCREW TCBL POZIDRIV 3.9X19
33	3100	SQUARE TUBE 16X16X1.5 (ML)
34	3108	BLOCKING FORK
35	4102	MOBILE SPRING BRACKET FOR BALANCER 62MM
36	1950	ALUMINIUM BALANCER TUBE (ML)
37	3106	FASTENNER FOR ALUMINIUM TUBE